

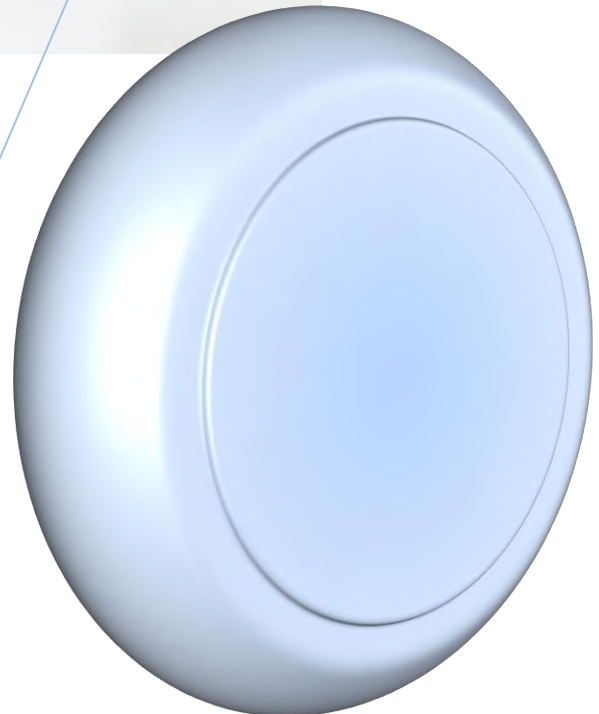

## MSS SP 97 Dimensions

Rajveer Stainless And Alloy





**RAJVEER STAINLESS AND ALLOYS**

MANUFACTURE AND SUPPLIER OF PIPES / FITTINGS / FASTNERS  
ISO 9001, 14001 : 2015 OHS 18001:2007 & PED 2014 / 68 / EU

## Check MSS SP 97 Dimensions

Mss Sp-97 Weldolet Is The Most Mostly Used Branch Connection. Mss Sp 97 Standard Covers Essential Tolerances, Mini Strength Requirements, Marking, Testing, Material, And Dimensions For 90 Degree And 45 Degree Integrally Reinforced Forged Branch Outlet Fittings Of Butt weld, Socket Weld, Threaded Types. We Produce Mss Sp-97 Weldolet, Mss Sp-97 Sockolet, Mss Sp-97 Thredolet For Which The Branch Diameter Is Available From 1/8 Inch To About 24 Along With The Wall Thickness.



NPS	PIPE	MSS SP 97 Dimensions											
		2"	3"	4"	6"	8"	10"	12"	14"	16"	18"	20"	24"
2"	STD-40 XS-80	70											
	XXS-160	87											
3"	STD-40 XS-80	84	91										
	XXS-160	101	119										
4"	STD-40 XS-80	97	103	111									
	XXS-160	114	132	144									
	STD-40	124	130	138	148								
6"	XS-80	124	130	138	165								
	XXS-160	141	159	171	192								
	STD-40	149	156	164	176	183							
8"	XS-80	149	156	164	191	197							
	XXS-160	167	184	197	218	224							
	STD-40	176	183	191	205	210	218						
10"	XS-80	176	183	191	218	238	235						
	XXS-160	194	211	224	245	251	265						
	STD	202	208	216	228	255	245	251					
12"	XS	202	208	216	243	264	267	265					
	XXS-160	219	237	249	270	276	291	324					
14"	STD	218	224	232	245	251	259	267	270				
	XS	218	224	231	239	279	270	278	286				
16"	STD	243	249	257	270	276	284	292	295	300			
	XS	243	249	257	284	305	293	303	306	319			

**RAJVEER STAINLESS AND ALLOYS**MANUFACTURE AND SUPPLIER OF PIPES / FITTINGS / FASTNERS  
ISO 9001, 14001 : 2015 OHS 18001:2007 & PED 2014 / 68 / EU**MSS SP-97 Standard Size**

Weldolet Size (inch)	A	B	C	D	Weldolet weight in lbs
1/2	3/4	1 3/8	15/16	5/8	0.15
3/4	7/8	1 5/8	1 3/16	13/16	0.25
1	1 1/16	2	1 7/16	1 1/32	0.4
1 1/4	1 1/4	2 3/8	1 3/4	1 3/8	0.7
1 1/2	1 5/16	2 7/8	2	1 5/8	0.8
2	1 1/2	3 1/2	2 9/16	2 1/16	1.5
2 1/2	1 5/8	4 1/6	3	2 7/16	2.25
3	1 3/4	4 13/16	3 11/16	3 1/16	3.75
3 1/2	2	5 3/8	3 7/8	3 9/16	5
4	2	6	4 3/4	4	6.7
5	2 1/4	7 1/8	5 9/16	5 1/16	8.5
6	2 3/8	8 1/2	6 11/16	6 1/16	14
8	2 3/4	10 3/8	8 11/16	7 15/16	28



**RAJVEER STAINLESS AND ALLOYS**

MANUFACTURE AND SUPPLIER OF PIPES / FITTINGS / FASTNERS  
ISO 9001, 14001 : 2015 OHS 18001:2007 & PED 2014 / 68 / EU

## Standard Specification Of MSS SP-97 Sockolet And MSS SP-97 Threadolet.

### Specification MSS SP 97

**MSS SP-43** Corrosion Resistant Applications, Fabricated and Wrought Butt-Welding Fittings for Low Pressure

**MSS SP-95** Bull Plugs & Swage(d) Nipples

**BS3799** Specification of screwed and Socket-welding, Steel pipe fittings

**ASTM A182** Standard Specification for Wrought Austenitic Stainless Steel Piping Fittings





## RAJVEER STAINLESS AND ALLOYS

MANUFACTURE AND SUPPLIER OF PIPES / FITTINGS / FASTNERS  
ISO 9001, 14001 : 2015 OHS 18001:2007 & PED 2014 / 68 / EU

### MSS SP-97 Thickness and Rating

Type	Class	Branch Size	W.T of Pipe
Weld Outlet	Standard(STD)	1/8"~24"	STD
Weld Outlet	Extra Strong(XS)	1/8"~24"	XS
Weld Outlet	SCH 160	1/2~6"	SCH 160
Socket Outlet And Thread Outlet	3000	1/8"~4"	XS
Socket Outlet And Thread Outlet	6000	1/2"~2"	SCH 160



## MSS SP-97 Sockolet Dimensions

Dimension	MSS SP-97 Sockolet					Full Size		
	A		B		Weight	C(1)		Weight
	mm	inches	mm	inches	kg	mm	inches	kg
1/8"	19.0	3/4"	16.0	5/8"	0.06			
1/4"	19.0	3/4"	16.0	5/8"	0.06			
3/8"	20.5	13/16"	19.0	3/4"	0.09			
1/2"	25.5	1"	24.0	15/16"	0.11	14.0	9/16"	0.12
3/4"	27.0	1 1/16"	30.0	1 3/16"	0.17	19.0	3/4"	0.19
1"	33.5	1 5/16"	36.5	1 7/16"	0.29	24.0	15/16"	0.31
1 1/4"	33.5	1 5/16"	44.5	1 3/4"	0.41	32.0	1 1/4"	0.45
1 1/2"	35.0	1 3/8"	51.0	2"	0.46	38.0	1 1/2"	0.50
2"	38.0	1 1/2"	65.0	2 9/16"	0.80	49.0	1 15/16"	0.87
2 1/2"	46.0	1 13/16"	76.0	3"	1.40	59.0	2 5/16"	1.50
3"	51.0	2"	93.5	3 11/16"	2.00	73.5	2 7/8"	2.15
3 1/2"	54.0	2 1/8"	101.5	4"	2.60	85.0	3 5/16"	2.80
4"	57.0	2 1/4"	120.5	4 3/4"	3.30	97.0	3 13/16"	3.50

**MSS SP-97 Standard Manufacturer In India.**

## MSS SP-97 Weldolet

NPS dimension	MSS SP-97 Weldolet Dimensions					full size		
	A		B		weight	C		weight
	mm	inches	mm	inches	kg	mm	inches	kg
1/8"	28,00	1-1/8"	14,00	9/16"	0,15	11,50	7/16"	0,15
3/4"	32,00	1-1/4"	19,00	3/4"	0,32	15,50	5/8"	0,32
1"	38,00	1-1/2"	25,50	1"	0,38	21,00	13/16"	0,38
1-1/4"	44,00	1-3/4"	33,50	1-5/16"	0,55	29,50	1-3/16"	0,60
1-1/2"	51,00	2"	38,00	1-1/2"	0,80	34,00	1-5/16"	0,85
2"	55,00	2-3/16"	43,00	1-11/16"	0,97	43,00	1-11/16"	1,00
2-1/2"	62,00	2-7/16"	54,00	2-1/8"	1,55	54,00	2-1/8"	1,70
3"	73,00	2-7/8"	73,00	2-7/8"	2,85	66,50	2-5/8"	2,95
4"	84,00	3-5/16"	98,50	3-7/8"	4,75	87,00	3-7/16"	4,95
5"	94,00	3-11/16"	122,00	4-13/16"	6,50	109,50	4-5/16"	6,80
6"	105,00	4-1/8"	146,00	5-3/4"	12,70	132,00	5-3/16"	13,70



## MSS SP-97 Threadolet

NPS Dimension	MSS SP-97 Threadolet Dimensions					Full Size		
	A		B		Weight	C		Weight
	mm	inches	mm	inches	kg	mm	inches	kg
1/8"	19.0	3/4"	16.0	5/8"	0.06			
1/4"	19.0	3/4"	16.0	5/8"	0.06			
3/8"	21.0	13/16"	19.0	3/4"	0.09			
1/2"	25.0	1"	24.0	15/16"	0.11	14.0	9/16"	0.12
3/4"	27.0	1 1/16"	30.0	1 3/16"	0.17	19.0	3/4"	0.19
1"	33.0	1 5/16"	36.0	1 7/16"	0.29	24.0	15/16"	0.31
1 1/4"	33.0	1 5/16"	44.5	1 3/4"	0.41	32.0	1 1/4"	0.45
1 1/2"	35.0	1 3/8"	51.0	2"	0.46	38.0	1 1/2"	0.50
2"	38.0	1 1/2"	65.0	2 9/16"	0.80	49.0	1 15/16"	0.87
2 1/2"	46.0	1 13/16"	76.0	3"	1.74	59.0	2 5/16"	1.50
3"	51.0	2"	93.5	3 11/16"	2.00	73.5	2 7/8"	2.15
4"	57.0	2 1/4"	120.5	4 3/4"	97.0	97.0	3 13/16"	3.60



**RAJVEER STAINLESS AND ALLOYS**

MANUFACTURE AND SUPPLIER OF PIPES / FITTINGS / FASTNERS  
 ISO 9001, 14001 : 2015 OHS 18001:2007 & PED 2014 / 68 / EU